

**Highly affordable laser
multifunction printer with
professional colour results.**

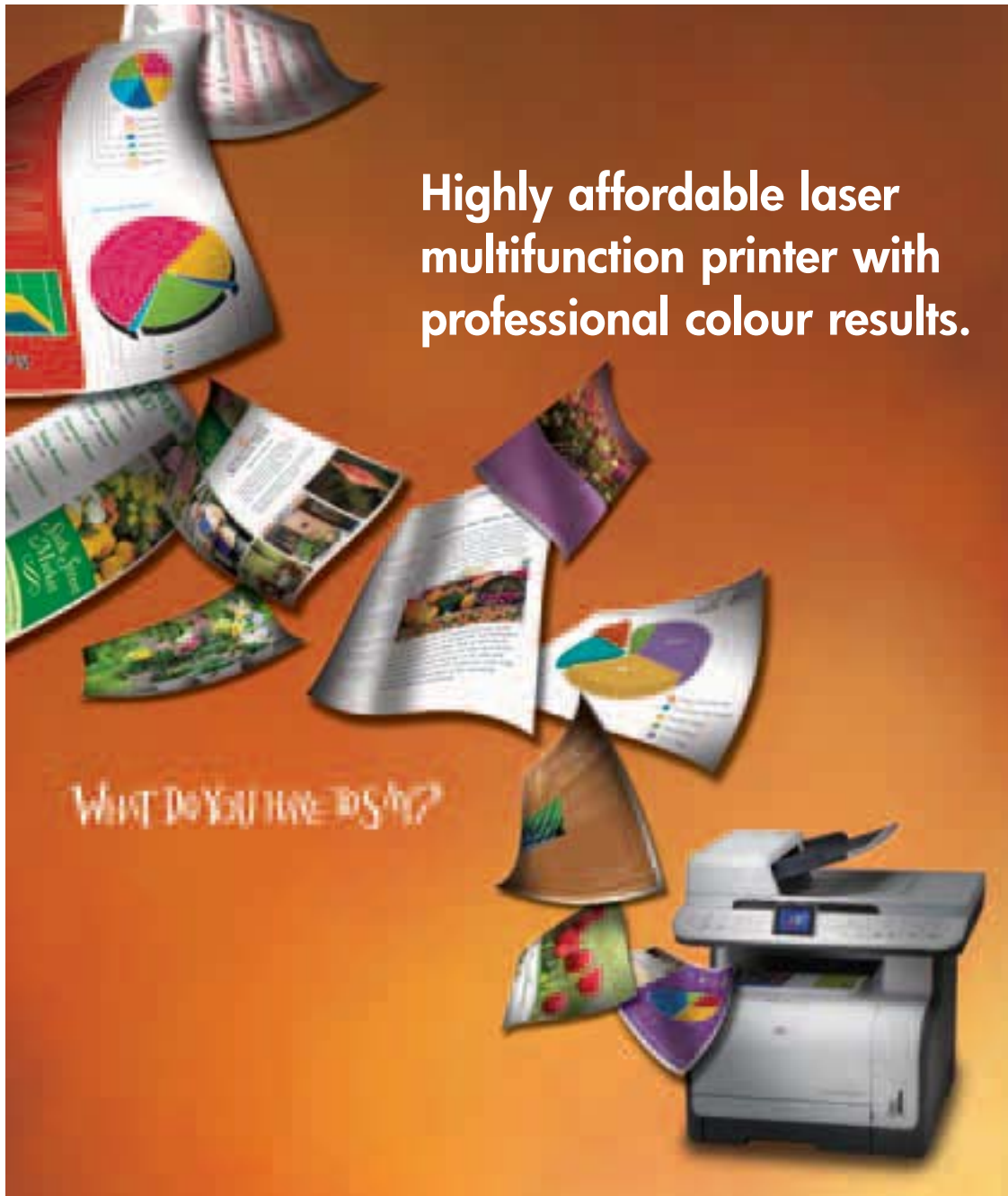

WHAT DO YOU HAVE TO SAY?

HP Color LaserJet CM1312 MFP series



Professional, high quality results

Through innovative printing technologies such as HP ImageREt 3600 and the new generation HP ColorSphere toner, the HP Color LaserJet CM1312 MFP series deliver sharp and vibrant results for professional-looking collateral in-house — giving you the ability to manage marketing materials and budget, and helping to take your business to the next level.

Superior image enhancements. HP ImageREt 3600 uses multi-layering technology and adaptive halftoning to produce high quality images, text and graphics.

Innovative print technologies for best results

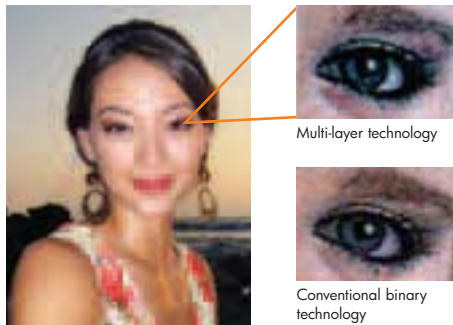

Professional-quality documents. New generation HP ColorSphere toner is chemically-grown and spherical in shape to deliver increased dynamic range of colours and gloss levels for professional-looking documents in-house.

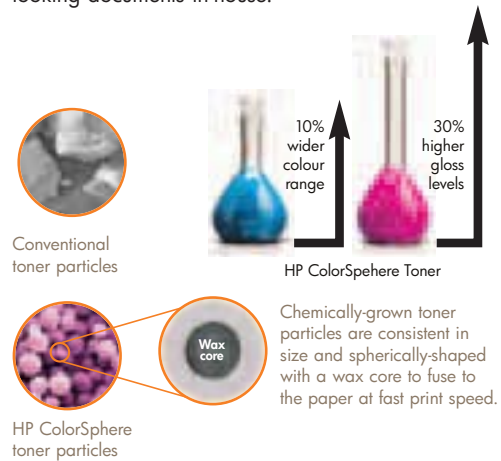

Get your prints, fast. With its four individual cartridges aligned in fixed positions, each colour is applied directly to the paper with just a single pass for smoother and faster print results.

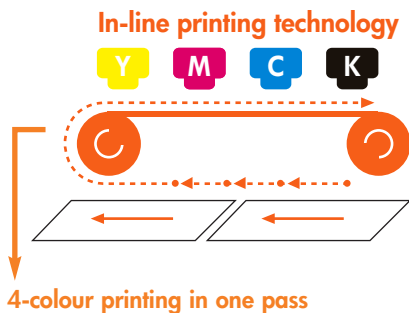

Automatic photo mode for print and copy.

Enjoy the best image quality automatically as the MFP can intuitively detect the type of media and optimise output quality. Or, simply choose the printing and copying preference menus for best possible results.





Digitise quickly and easily. Capture high quality images and documents to incorporate into presentations. What's more, the flatbed CCD scanner¹ is great for scanning books, ledgers and 3-D objects.

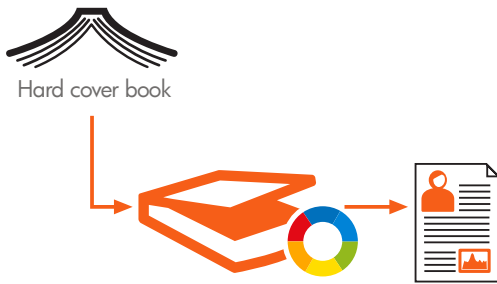

Versatile printing options. The MFP supports a broad range of media from 76 x 127 mm to 216 x 356 mm, and from everyday to speciality papers, making it easy to create a variety of business documents and marketing materials.

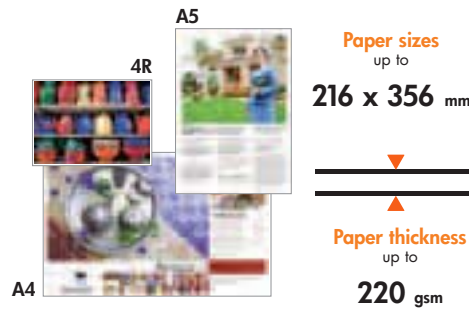

Create high-impact collateral with added tools.

Create and print high quality, professional marketing materials easily with:

- Marketing Resources Centre², a resource-rich Web portal provides professionally-designed templates, free online training and links to other design resources (Included in printer's installation software)
- Complimentary HP In-house Marketing Starter Kit with over 100 design templates for creating documents
- 3 types of sample specialty papers, valuable discounts on stock images and logo creation are bundled with the MFP

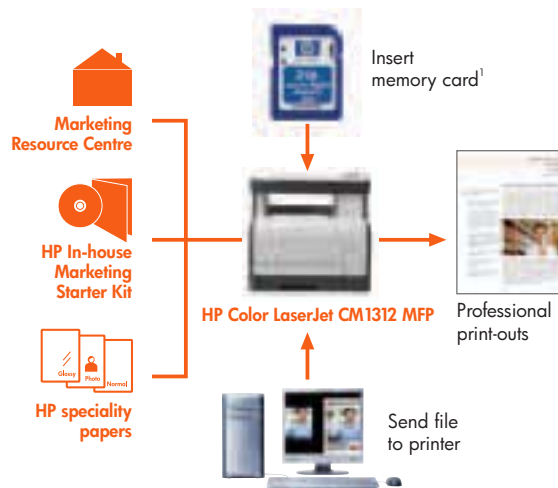

¹ Only available for HP Color LaserJet CM1312nfi MFP.

² The Marketing Resources Software may be downloaded for free through the URL included with the MFP's installation software. For more information, visit www.hp.com/go/ihm

Give your business a productivity boost

Innovative features transform the way you print, copy, scan and fax¹, and improve document workflow in your office.



Save with instant results. Print fast first-page-out in less than 8.5 seconds. With Instant-on technology², the Time To Completion (TTC)³ of a typical office print job is two times faster from low power mode than on devices without it. This technology also uses up to 50% less energy than traditional fusing, making it more energy-efficient. Lower power consumption translates to lower utility bills.

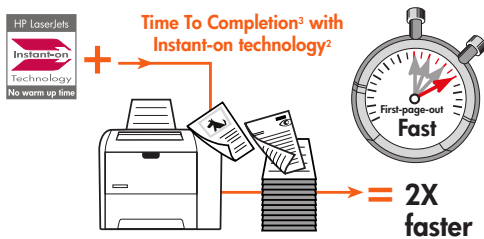

Save time, cost and energy. Get instant copies and scans with Instant-on Copy. Utilising LED light source — an already-stable, instant-on light source — it does not require warm-up for scanning so copy jobs can begin quickly from low power mode. This LED based technology is cleaner, more reliable and energy-efficient so you can reduce the cost of owning a MFP.

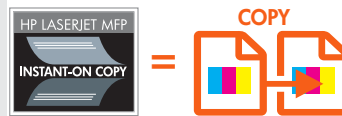

Walk-up scan-to convenience. With scan-to features, you can scan documents to network folder or email directly from the MFP without using a PC.

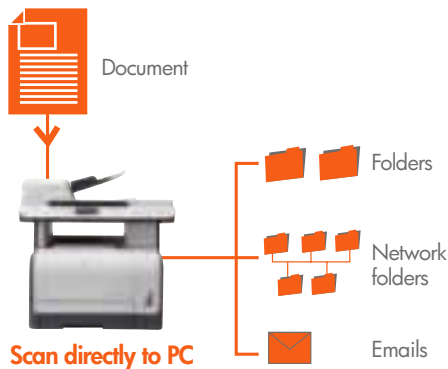

Simplify document workflow and save on cost. Send and receive fax on your PC via the MFP for greater convenience without having to print, and your business can save on printing cost while enjoying improved productivity.

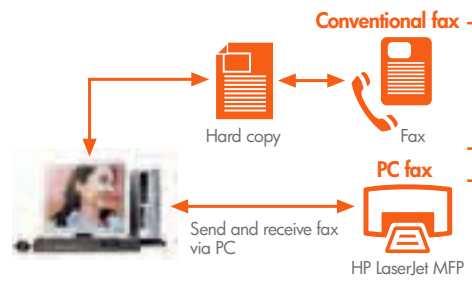

¹ Only available for HP Color LaserJet CM1312nfi MFP.

² Instant-on technology uses cutting-edge fuser technology to produce the first page faster when a printer is coming out of low power mode so the print job is done sooner.

³ An InfoTrends study shows the typical office print job is three to five pages long: www.infotrends.com/public/Content/Presentations/officeprinteruse.pdf
See HP average print time versus competition: www.hp.com/go/whywait

Design features for ease of use

The HP Color LaserJet CM1312 MFP series is designed to be easy to install, use and maintain. With its thoughtful features and functionality such as installation wizards, intuitive control panel and integrated networking capability, it's the best office device to share and multi-task efficiently.



Flatbed scanner
captures documents, photos, and 3D objects such as books, ledgers, magazines, and thick, bound files.

Readiris Pro OCR software
scans documents by converting images and text into a form that can be easily edited in the computer.

Scan-to functionality
scans documents and images directly to an email or folder using the MFP.

Intuitive control panel
for simple navigation and ease-of-use.

10/100 Base-T networking¹
lets you connect the MFP to a network so multiple users can take advantage of the device's functions.

Photo memory card slots¹
allows easy access and printing of photos directly from the MFP without a PC.

2.4-inch colour graphical display¹
supports localised languages, photo preview of thumbnail images and shows device status.

Express installer and the enterprise installer
enables quick and easy set-up, installation and configuration of the device to specific preferences.

HP Color LaserJet CM1312nfi MFP shown

¹ Only available for HP Color LaserJet CM1312nfi MFP.

HP LaserJet quality and reliability

Backed by renowned HP reliability and support, your business can have total confidence and peace of mind with the HP Color LaserJet CM1312 MFP series.



PC Magazine Readers' Choice Award for service and reliability for 16 straight years.

September 18, 2007—HP Printers

PC Magazine Readers' Choice Award Logo is a trademark of Ziff Davis Publishing Holdings Inc. Used under license.



Around the clock service and support

HP LaserJets are backed with a one-year limited warranty including phone support 24/7 one-stop access to tools and information for self-help troubleshooting. You can also choose to enhance your warranty protection with a wide selection of affordable HP Care Pack Services.

The HP Color LaserJet CM1312 MFP series is a full-featured multifunction device designed to meet all your printing and imaging needs. With innovative print technologies and in-house marketing tools, your business can create high quality marketing materials, and communicate and sell more effectively. This device is the complete business colour solution for your office that stretches your potential, not your budget.

The HP Color LaserJet CM1312 MFP series lets you print, copy, scan and fax¹ while delivering professional colour results — all in one compact design.

PRINT

- Professional print speed² of up to 12 ppm black, 8 ppm colour
- Time to Completion³ for a typical print job in as fast as 34 seconds with Instant-on technology⁴
- Print graphics-intensive files fast with 160 MB RAM memory and 430 MHz processor
- HP ImageREt 3600 provides consistent, professional results, right out of the box

SCAN

- 24-bit CCD colour scanner converts printed materials to digital information
- Professional scans at resolutions up to 1200 dpi
- Remote scanning via Scan-to software
- Turn scanned text into editable files with Readiris Pro OCR Software

COPY

- Instant-on Copy with LED technology starts copy in seconds
- Reduce or enlarge copy jobs from 25 to 400% quickly

FAX¹

- Send and receive fax via PC to save time and enhance security when you want to with private receive
- Fax/Tel allows the device to monitor incoming calls, determine if a call is voice or fax, and ring to notify you of voice calls
- Store up to 250 fax pages with fax storage

IMAGING⁵

- Built-in photo memory card slots

HP Color LaserJet CM1312 MFP

PAPER HANDLING

- Expanded media support
- 50-sheet automatic document feeder (ADF)⁶
- 150-sheet multipurpose input tray
- 125-sheet face-down output bin
- 10-sheet priority slot

NETWORKING

- Hi-Speed G3⁷ 2.0 port, RJ-11 telephone port, line-out telephone port
- 10/100 networking port⁸

RELIABILITY

- Proven HP LaserJet MFP engine and HP's legendary reliability
- Backed by HP's award-winning customer service and support

¹ Only available for HP Color LaserJet CM1312 MFP.
² Exact speed varies depending on system configuration, software application, driver, and document complexity.
³ An independent study shows the typical office print job is less than five pages long. www.hp.com/go/officeprintjob
⁴ Instant-on technology uses cartridge-level technology to produce the first page faster when a printer is coming out of low power mode to the print job's drive status.
⁵ Device memory of 160 MB RAM for HP Color LaserJet CM1312 MFP, 128 MB RAM for HP Color LaserJet CM1312 MFP.

HP Color LaserJet CM1312 MFP (CC430A)

- Colour flatbed scanner
- 125-sheet output bin
- One-door access for easy cartridges replacement
- 150-sheet multipurpose tray
- Intuitive control panel with 2-line, 16-character LCD display
- A powerful 450 MHz processor and 128 MB memory
- Hi-Speed USB 2.0 port

Front view

Partial rear view I/O panel

HP Color LaserJet CM1312 MFP (CC431A)

- Colour flatbed scanner
- 125-sheet output bin
- One-door access for easy cartridges replacement
- 150-sheet multipurpose tray
- Intuitive control panel with 2-line, 16-character LCD display and built-in Help function
- A powerful 450 MHz processor and 128 MB memory
- Hi-Speed USB 2.0 port

Front view

Partial rear view I/O panel

All the features of the base model, plus:

- 50-sheet automatic document feeder
- Intuitive control panel with 2.4-inch colour graphical display and built-in Help function
- Reduction optics/charge-coupled device (RO/CCD) colour flatbed scanner
- Photo memory card slots
- Fax port
- 10/100 networking port
- 160 MB RAM memory

Maximise the performance of HP Color LaserJet CM1312 MFP series with HP accessories and supplies

CB264A
 Connect directly with the Hi-Speed USB A to B printer cable (6-foot).

Choose from a selection of HP papers to create professional-quality documents in your office.

CB540A, CB541A, CB542A, CB543A
 HP's chlorine-free print cartridges with new HP Smart Web Printing. The HP Color LaserJet CM1312 MFP series deliver consistent quality and reliable printing.

HP's commitment for a safer environment

With HP's Design for the Environment initiative, products are designed with their entire life cycle in mind — from product design to manufacturing, and from usage to recycling — in an effort to reduce energy, paper, packaging and materials used. By providing customers with safe, high quality products that are environmentally-sound throughout their life cycle, HP aims to reduce the environmental impact of our products, and that of our customers.

1 DESIGN FOR ENVIRONMENT

Conserve energy. With ENERGY STAR[®], the HP LaserJet CM1312 MFP series automatically reduces power consumption after a designated period of inactivity.

Lower power consumption. Save power automatically with energy intelligence that is built into HP printing products. Instant-on technology provides up to 50% energy savings over traditional laser while providing a fast first-page-out in seconds.

5 RECYCLE

Less waste through recycling. All returned Original HP print cartridges go through a multiphase recycling process where they are reduced to raw materials that are used to make new metal and plastic products.

2 MANUFACTURING

Use of fewer materials. HP LaserJet toner cartridge packaging uses 45% less materials compared to previous designs. The more compact package contains an innovative multi-chamber air bag that protects the cartridge from transport damage, dust, moisture and light, and 30% more cartridges can be shipped on one pallet (1500 more cartridges can be shipped in one ocean container).



3 USE

No more wasteful prints. Save paper with HP Smart Web Printing (a free download for users). It enables simple, predictable web printing and provides control over what you want and how you want it printed. You can select, store and organise text and graphics from multiple web pages, then edit and print exactly what you see on-screen, thereby making web printing more eco-friendly and less wasteful.

Use less paper. By printing on both sides with manual two-sided printing. Plus, easily produce 2-up and 4-up copies (multiple pages on a single sheet of paper) to conserve resources.



4 RETURN

Simplify the management and disposal of products. Through HP Planet Partners — a free, convenient return and recycling programme available in more than 40 countries.

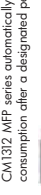

Design for Environment

Manufacturing

Use

Recycle

Return

¹ Programme availability varies. HP printing supplies return and recycling is currently available in more than 40 countries, territories and regions in Asia, Europe and North and South America through the HP Planet Partners programme.

HP Color LaserJet CM1312 MFP series

Technical specifications

	HP Color LaserJet CM1312 MFP (CC430A)	HP Color LaserJet CM1312nfi MFP (CC431A)
Print and copy speed¹	Black-and-white: up to 12 ppm; Colour: up to 8 ppm (A4/letter)	Black-and-white: up to 12 ppm; Colour: up to 8 ppm (A4/letter)
First-page-out	Black-and-white: as fast as 26 seconds from Ready mode; Colour: as fast as 32 seconds from Ready mode; Time To Completion for a typical office print job ² : as fast as 54 seconds (A4/letter)	Black-and-white: as fast as 26 seconds from Ready mode; Colour: as fast as 32 seconds from Ready mode; Time To Completion for a typical office print job ² : as fast as 54 seconds (A4/letter)
Resolution	Printing: up to 600 x 600 dpi; HP ImageREt 3600; HP ColorSphere toner, HP edgeenhancement technologies; Scanning: up to 1200 dpi optical resolution, up to 19,200 dpi enhanced resolution	Printing: up to 600 x 600 dpi; HP ImageREt 3600; HP ColorSphere toner, HP edgeenhancement technologies; Scanning: up to 1200 dpi optical resolution, up to 19,200 dpi enhanced resolution
Features	Up to 99 multiple copies, reduce/enlarge from 25 – 400%, contrast (lighter/darker), quality (copy optimise), number of copies, paper size, paper type, multi-page copy, collation, copy draft, image adjustment (brightness, contrast, sharpen, background removal, colour balance, greyness)	Up to 36.6 kbps, auto fax reduction, fax forwarding, fax polling (receive only), broadcasting (up to 120 locations), speed dial (up to 120 numbers), auto redialing, PC faxing supported, delayed sending, distinctive ring, telephone mode supported, up to 250 pages fax memory ³
Copying	Up to 99 multiple copies, reduce/enlarge from 25 – 400%, contrast (lighter/darker), quality (copy optimise), number of copies, paper size, paper type, multi-page copy, collation, copy draft, image adjustment (brightness, contrast, sharpen, background removal, colour balance, greyness)	Up to 36.6 kbps, auto fax reduction, fax forwarding, fax polling (receive only), broadcasting (up to 120 locations), speed dial (up to 120 numbers), auto redialing, PC faxing supported, delayed sending, distinctive ring, telephone mode supported, up to 250 pages fax memory ³
Faxing	—	Up to 36.6 kbps, auto fax reduction, fax forwarding, fax polling (receive only), broadcasting (up to 120 locations), speed dial (up to 120 numbers), auto redialing, PC faxing supported, delayed sending, distinctive ring, telephone mode supported, up to 250 pages fax memory ³
Scanning	Colour flatbed scanner, 54 x 70 mm (2.1 x 2.8 inch) to 216 x 297 mm (8.5 x 11.7 inch); Remote initiated scanning via HP Director, TWAIN compliant or WIA-compliant software, HP Solution Centre software; walk-up initiated scanning via front control panel (preconfiguration via software required); file types: BMP, GIF, JPEG, PNG, TIF, PDF	Colour flatbed scanner and automatic document feeder (ADF), 102 x 152 mm (4 x 6 inch) to 216 x 356 mm (8.5 x 14 inch); remote initiated scanning via HP Director, TWAIN-compliant or WIA-compliant software, HP Solution Centre software; walk-up initiated scanning via front control panel (preconfiguration via software required); file types: BMP, GIF, JPEG, PNG, TIF, PDF
Photo memory cards supported	—	CompactFlash Types I and II, Memory Stick, Memory Stick PRO, Memory Stick Duo, Secure Digital, MultimediaCard, xD-Picture Card
Processor	450 MHz	160 MB
Memory	128 MB	160 MB
Recommended monthly volume⁴	Up to 1,500 pages	Up to 30,000 pages
Maximum monthly duty cycle⁵	Up to 30,000 pages	Up to 30,000 pages
Paper	150-sheet multipurpose input tray, 125-sheet face-down output bin, two-sided printing (manual)	150-sheet multipurpose input tray, 125-sheet face-down output bin, two-sided printing (manual)
Handling	76 x 127 mm (3 x 5 inch) to 216 x 356 mm (8.5 x 14 inch); A4, A5, A6, B5 (ISO, JIS), letter, legal, executive, envelopes (No. 10, Monarch)	76 x 127 mm (3 x 5 inch) to 216 x 356 mm (8.5 x 14 inch); A4, A5, A6, B5 (ISO, JIS), letter, legal, executive, envelopes (No. 10, Monarch)
Sizes	60 to 176 g/m ² (16 to 47 lb), up to 200 g/m ² (53 lb) with HP Laser Cover papers, up to 220 g/m ² (59 lb) with HP Laser Glossy Photo papers	60 to 176 g/m ² (16 to 47 lb), up to 200 g/m ² (53 lb) with HP Laser Cover papers, up to 220 g/m ² (59 lb) with HP Laser Glossy Photo papers
Weights	Paper (board, brochure, colour, glossy, letterhead, photo, plain, preprinted, prepunctured, recycled, rough), transparencies, labels, envelopes, cardstock	Paper (board, brochure, colour, glossy, letterhead, photo, plain, preprinted, prepunctured, recycled, rough), transparencies, labels, envelopes, cardstock
Connectivity	Hi-Speed USB 2.0 port	Hi-Speed USB 2.0 port, 10/100 Base TX with RJ45 connector, 2 RJ11 ports, photo memory card slot
Interfaces	—	Hi-Speed USB 2.0 port, 10/100 Base TX with RJ45 connector, 2 RJ11 ports, photo memory card slot
Languages	HP PCL 6, HP Postscript Level 3 emulation, HP PCL5c emulation; Fonts: 80 TrueType PCL 6, 80 TrueType PostScript	HP PCL 6, HP Postscript Level 3 emulation, HP PCL5c emulation; Fonts: 80 TrueType PCL 6, 80 TrueType PostScript
Client operating system	Microsoft® Windows® 2000, Windows XP® Home, Windows XP Professional, Windows Server 2003, Certified for Windows Vista®, Mac OS X v10.3, v10.4, v10.5 and later	Microsoft® Windows® 2000, Windows XP® Home, Windows XP Professional, Windows Server 2003, Certified for Windows Vista®, Mac OS X v10.3, v10.4, v10.5 and later
Network operating system	—	Windows 2000 (print drivers only), XP Home, XP Professional, XP 64-bit, Windows Server 2003/2008, Windows Vista®, Mac OS X v10.3 or higher; Red Hat/SuSE Linux 6.x or higher, Novell NetWare 3.2 or higher (NDPS/TCP/IP only); Citrix MetaFrame (print only); Windows Terminal Services (print only) ⁶
Network protocol	—	Via builtin networking solution: TCP/IP, IPv4, IPv6; Print: TCP/IP port 9100 Direct Mode, IPD (raw que support only), Web Services Printing; Photo card, CIFS; Discovery: SIP, Bonjour, Web Services Discovery; IP Config: IPv4 (BootP, DHCP, AutoIP, Manual), IPv6 (Stateless LinkLocal and via Router, Stateless DHCPv6); Management: SNMPv1, HTTP
Minimum system requirements	PC: Server 2003; any Pentium III processor or higher, 64 MB RAM, 50 MB available hard disk space, SVGA 800 x 600 monitor with 16-bit colour (print driver, scan driver only); Windows 2000®: XP Home, XP Professional; any Pentium III processor (Pentium III or higher recommended), 128 MB RAM, 250 MB available hard disk space, SVGA 800 by 600 monitor with 16-bit color; Intel® Explorer 5.5 or higher (full install); 1 GHz processor, 512 MB RAM (Windows Vista®), check user guide for minimum hard drive space; CD-ROM drive (USB port); Macintosh: Mac OS X v10.3.9, v10.4, v10.5; PowerPC G3, G4, or G5 processor; Intel Core processor; 80 MB RAM, 30 MB available hard disk space; USB port; CD-ROM drive	PC: Server 2003; any Pentium III processor or higher, 64 MB RAM, 50 MB available hard disk space, SVGA 800 x 600 monitor with 16-bit colour (print driver, scan driver only); Windows 2000®: XP Home, XP Professional; any Pentium III processor (Pentium III or higher recommended), 128 MB RAM, 250 MB available hard disk space, SVGA 800 by 600 monitor with 16-bit color; Intel® Explorer 5.5 or higher (full install); 1 GHz processor, 512 MB RAM (Windows Vista®), check user guide for minimum hard drive space; CD-ROM drive (USB port); Macintosh: Mac OS X v10.3.9, v10.4, v10.5; PowerPC G3, G4, or G5 processor; Intel Core processor; 80 MB RAM, 30 MB available hard disk space; USB port; CD-ROM drive
Dimensions (w x d x h)	437 x 455 x 405 mm (17.2 x 17.9 x 16 inch)	497 x 490 x 485 mm (19.6 x 19.3 x 19.1 inch)
Weight	21.2 kg (46.7 lb)	24.7 kg (54.5 lb)

What's in the box

MFP, preinstalled introductory 750-page black, cyan, magenta, and yellow HP Color LaserJet print cartridges with ColorSphere toner, in-box documentation (Getting Started Guide, support flyer), CD (User's Guide and device software), power cable, control panel faceplate, Readings PRO OCR software and registration card, Marketing Starter Kit (includes specialty media sampling discounts to partner offerings, specialty templates), USB cable

Warranty

One-year, return to authorised service centre, limited hardware warranty; telephone and Web support (varies according to region)

Environmental ranges

Temperature
Recommended: 20 – 27° C (68 – 81° F); Storage: 20 – 40° C (4 – 104° F)

Relative humidity
Recommended: 20 – 70%; Storage: 10 – 95%

Altitude
0 to 3,048 m (0 to 10,000 ft)

Power consumption
Active, print: 295 watts; copy: 310 watts; Ready: 21 watts; Sleep: 7.2 watts; Off: 0 watts; Typical Electricity Consumption (TEC): 1.597 kWh/Week; ENERGY STAR® qualified models, see www.hp.com/go/energystar

Acoustics⁷

Sound power Active, print: 6.1 B(A); copy: 6.4 B(A); Ready: inaudible; Bystander sound pressure Active, print: 47 dB(A); copy: 50 dB(A); Ready: inaudible

Required input voltage⁸

110 – 127 V (±10%), 60 Hz (±3 Hz); 220 – 240 V (±10%), 50 Hz (±3 Hz)

Power certifications

CM1312/CM1312nfi: EMC: CISPR 22: 2005/EN 55022; 2006 Class B, EN 61000-3-2; 2000+A2, EN 61000-3-3; 1995+A1, EN 55024; 1998+A1+A2, FCC Title 47 CFR, ICES-003, G99254-1998, other EMC approvals as required by individual countries Safety: IEC 609501 (International), IEC 60825 1+A1+A2, EN 608251+A1+A2 (Class 1 Laser/LED Device) G84943-2001, other safety approvals as required by individual countries **CM1312nfi:** Telecom: ES 203 021, FCC Part 68, PTC 200 (New Zealand), AS/ACHF 5002: 2001 (Australia), IDA P51N1 (Singapore), TSP00201 (Malaysia), IG 000531 (Taiwan), HKCA 2011 (Hong Kong SAR), YD/1589 YD703, G83382 Typical Electricity Consumption (TEC): 1.597 kWh/Week (China); other Telecom approvals as required by individual countries

HP SureSupply

To learn more, visit www.hp.com/learn/suresupply

- Exact speed varies depending on system configuration, software application, device, and document complexity.
- An Indian's study shows the typical office print job is three to five pages long; www.researchgate.net/publication/318919918/abstract
- Print job based on HP and select competing products. Actual results may vary.
- Based on standard IUT1 test image #1, at standard resolution. More complicated pages or higher resolution will take longer and use more memory.
- HP recommends that the number of printed pages per month be within the stated range for optimum device performance, based on factors including supplies replacement intervals and device life over an extended warranty period.
- Duty cycle is defined as the maximum number of pages per month of imaged output. This value provides a comparison of product robustness in relation to other HP LaserJet or HP Color LaserJet devices, and enables appropriate deployment of printers and MFPs.
- Not all protocol and operating system configurations are supported. For more information, go to www.hp.com/support/net_printing

⁷ Hydrology cartridges: Average continuous composite cyan/yellow/magenta cartridge yield 750 pages and average continuous black cartridge yield 750 pages. Replacement cartridges: Average continuous composite cyan/yellow/magenta cartridge yield 1,400 standard pages and average continuous black cartridge yield 2,200 standard pages. Declared yield values in accordance with ISO/IEC 19798. Actual yields vary considerably based on images printed and other factors. For more information, visit www.hp.com/go/learnaboutsupplies

⁸ Configuration tested: imaging model, simplex printing, A4 paper at an average of 12 ppm.

⁹ Power requirements are based on the country/region where the printer is sold. Do not convert operating voltages. This will damage the printer and void the product warranty.



ENERGY STAR and the ENERGY STAR mark are U.S. registered marks. Microsoft, Windows, Windows Vista and Windows XP are U.S. registered trademarks of Microsoft Corporation in the United States and/or other countries.

© Copyright 2008 Hewlett-Packard Development Company, L.P. The information contained herein is subject to change without notice. The only warranties for HP products and services are set forth in the express warranty statements accompanying such products and services. Nothing herein should be construed as constituting an additional warranty. HP shall not be liable for technical or editorial errors or omissions contained herein.

Printed in Singapore, 20080054EEP, April 2008

Ordering information

Number
CC430A
CC431A

HP Color LaserJet CM1312 MFP
HP Color LaserJet CM1312nfi MFP

Replacement print cartridges⁹

HP Color LaserJet Black Print Cartridge
HP Color LaserJet Cyan Print Cartridge
HP Color LaserJet Yellow Print Cartridge
HP Color LaserJet Magenta Print Cartridge

Connectivity

G6264A Hi-Speed USB A to B printer cable (6-foot)
G6220A Hi-Speed USB 2.0 A to B printer cable (9-foot)
C7535A Network cable (7-foot)*
C7536A Network cable (14-foot)*
C7537A Network cable (25-foot)*
C7542A Network cable (50-foot)*

Service and support

H3110E HP Network Install Initial/Personal LaserJet Service*
H4533E HP Install Service
HC128PE HP 1-year Post-warranty Phone Assist Service
HE199E HP 3-year Return Hardware Service
UE201A HP 3-year Next Business Day Exchange Service
UE201E HP 3-year Next Business Day Exchange Service
UE625A HP 2-year/1-line Replace Service
UE626E HP 2-year/1-line Replace Service
UE633E HP 2-year Next Business Day Exchange Service
UE643E HP 1-year Post-warranty Return Service
UE645E HP 1-year Post-warranty/1-line Replace Service
UE668E HP 1-year Post-warranty/Next Business Day Exchange Service

* Only for HP Color LaserJet CM1312nfi MFP.

Paper

Asia Pacific: www.hp.com/apac/printingsupplies
Australia: 65-6253-8500
Australia/New Zealand: 6129972299 (AR)

Solutions

www.hp.com/go/gsc

HP Customer Information Centre (for product information)

Australia 13 23 47
China 800 820 2255
India 800 938 8339
Hong Kong 1600 425 4999 (from MTR/BSNLIAN line)
India 3030 4499 (from mobile)
Indonesia 0800 111 222
Korea 080 703 0700
Malaysia 1800 95 9849
New Zealand 1800 733 3434
Philippines 1800 278 8168
Singapore 0900 278 686
Taiwan 4649 353 9000
Thailand 4648 930 2814
Vietnam 4648 930 2814

Bangladesh, Bhutan, Brunei, Cambodia, Maldives, Nepal, Pakistan, Sri Lanka: Fax +65 6275 6707

HP Customer Care Centre (for post-sales service)

Australia 13 10 47
China 800 810 3888
Hong Kong 4852 3002 8555
India +62 21 350 3408
Indonesia +62 21 350 3408
Korea +82 23270 0700
Malaysia 1800 805 405
New Zealand 0800 449 553
Philippines +63 2 867 3551
Singapore +65 6 272 5300
Taiwan +886 2 8722 8000
Thailand +662 353 9000
Vietnam +848 823 4530



invent